

April 14th, 2015

To: Planholders of SAP 042-598-043

ADDENDUM #1

The Governing Specifications on Sheet 1 of 18 sheets has been updated to read the following:

The 2014 Edition of the Minnesota Department of Transportation “Standard Specifications for Construction” shall Govern.

The first sentence in the construction notes on Sheet 2 of 18 sheets has been updated to read the following:

The 2014 Edition of the Minnesota Department of Transportation “Standard Specifications for Construction” shall Govern.

Please find attached the amended plan sheets for the above mentioned project.

Please call our office at 507-532-8205 if you have any questions concerning this Addendum.

Sincerely,



Aaron VanMoer, PE
Lyon County Engineer

MINNESOTA DEPARTMENT OF TRANSPORTATION LYON COUNTY

CONSTRUCTION PLAN FOR BRIDGE NO. 42568

LOCATED 1.0 MILES N. OF JCT. C.S.A.H. 8 ON C.R. 67 OVER THREE MILE CREEK,
6.7 MILES N. OF MARSHALL, MN (Geographical Description)

SEC. 2 TWP. 112 N R 41 W (Legal Description)
STATE AID PROJ. NO. 042-598-043

GROSS LENGTH	82.67 FEET	0.016 MILES
BRIDGES-LENGTH	82.67 FEET	0.016 MILES
EXCEPTIONS-LENGTH	FEET	MILES
NET. LENGTH	82.67 FEET	0.016 MILES

GOVERNING SPECIFICATIONS

THE 2014 EDITION OF THE MINNESOTA DEPARTMENT OF TRANSPORTATION "STANDARD SPECIFICATION FOR CONSTRUCTION" SHALL GOVERN.

LIST OF SHEETS

NO.	TITLE
1	TITLE SHEET
2	GENERAL PLAN & ELEVATION
3	TYPICAL SECTION & QUANTITIES
4	BRIDGE LAYOUT
5-6	ABUTMENT
7-8	PIER
9-11	SUPERSTRUCTURE
12	CONCRETE BARRIER (TYPE F, TL-4)
13-16	MISC. BRIDGE DETAILS
17	BRIDGE SURVEY
18	BRIDGE SURVEY ~ PLAN & PROFILE

THIS PLAN CONTAINS 18 SHEETS.

- PLAN SYMBOLS**
- COUNTY LINE
 - TOWNSHIP OR RANGE LINE
 - SECTION LINE
 - QUARTER LINE
 - SIXTEENTH LINE
 - EXISTING R/W
 - NEW R/W
 - TEMP EASE
 - RAILROAD R/W
 - UNSURFACED RD. OR SHLD.
 - EDGE OF LAKE
 - SWAMP BOUNDARY
 - MISCELLANEOUS BOUNDARY
 - CORPORATE OR CITY LIMITS
 - VACATED PLATTED PROPERTY
 - RECREATIONAL TRAIL
 - ALIGNMENT STATIONS
 - ALIGNMENT POINTS
 - RIVER OR CREEK
 - DRAINAGE DITCH
 - BRIDGE
 - RAILROAD (SINGLE TRACK)
 - RR CROSSING PAVEMENT MARKING
 - RR CROSSING GATE
 - RR CROSSBUCK SIGN
 - RR CROSSBUCK SIGN W/LIGHTS
 - BARBED WIRE FENCE
 - CHAIN LINK FENCE
 - WOVEN WIRE, COMBINATION WOVEN AND BARB
 - WOOD FENCE
 - BILLBOARD
 - RETAINING WALL
 - GUARDRAIL (CABLE)
 - GUARDRAIL (PLATE BEAM)
 - DRAIN TILE
 - CULVERT
 - CULVERT WITH APRONS
 - WOODS OR BRUSH, NURSERY
 - DECIDUOUS TREES
 - CONIFER (EVERGREEN) TREES
 - HEDGE
 - BUSH OR SHRUB
 - STUMP
 - SWAMP OR MARSH
 - MONUMENT (CI,ACT,ACP,BCP,...)
 - CONCRETE OR STONE MONUMENT
 - IRON PIPE
 - IRON PIN OR REBAR
 - IRON PIN WITH BRASS DISK
 - NAIL, PK NAIL, SPIKE, SFP, T-BAR, ...
 - VERTICAL CONTROL
 - HORIZONTAL CONTROL
 - POWER POLE
 - LIGHT POLE
 - LIGHT AND TELEPHONE POLE
 - LIGHT, TELEPHONE AND POWER POLE
 - GUY POLE
 - POLE ANCHOR
 - TELEPHONE POLE
 - TELEPHONE AND POWER POLE
 - UNDERGROUND CABLE PEDESTAL
 - TELEPHONE MANHOLE (VAULT)
 - ELECTRIC CABLE IN CONDUIT
 - TELEPHONE CABLE IN CONDUIT
 - BURIED ELECTRIC CABLE
 - BURIED TELEPHONE CABLE
 - GAS LINE
 - WATER LINE
 - VALVE
 - FIRE HYDRANT
 - WATER MANHOLE
 - WELL
 - LAWN SPRINKLER HEAD
 - MANHOLE
 - CATCH BASIN
 - SEPTIC TANK
 - FORCE MAIN LIFT STA.
 - SEWER LINE
 - PERMANENT BARRICADE
 - TRAFFIC SIGNAL LIGHT
 - HAND HOLE
 - ENTRANCE
 - BUILDING
 - SATELLITE DISH
 - STEEL TOWER
 - FLAG POLE

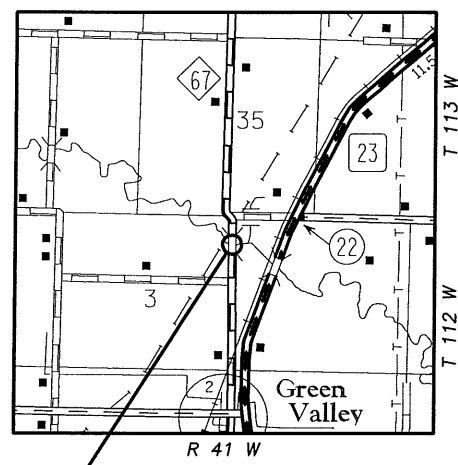

PROP. BRIDGE NO. 42568
S.A.P. 042-598-043
BEG. PROJ. STA. 45+04.67
END PROJ. STA. 45+87.33
EXIST. BRIDGE NO. 5101B
STEEL LOW TRUSS
LENGTH: 61.3'
ROAD WIDTH: 28.0'
YEAR BUILT: 1931
YEAR REMODELED: 1989

PROJECT LOCATION
Outline Map of Minnesota showing location of the County within the State.

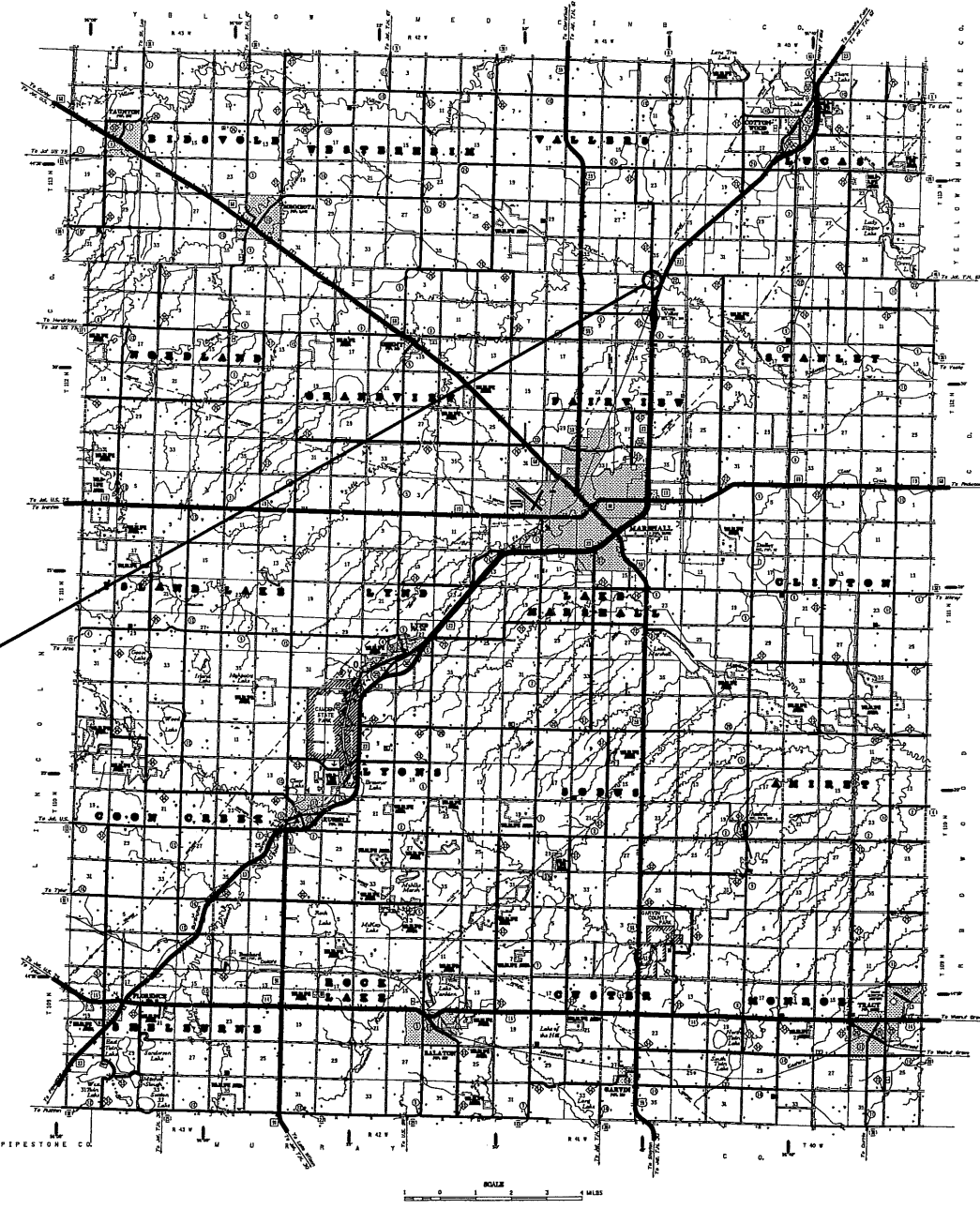
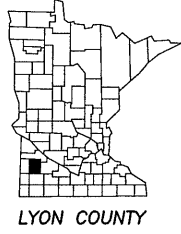

DESIGN DESIGNATION FOR:

FUNCTIONAL CLASSIFICATION	C.R. 67
RURAL LOCAL	
NO. OF TRAFFIC LANES	2
NO. OF PARKING LANES	N/A
DRIVING LANE WIDTH	11'
SHOULDER WIDTH	3'
ADT (CURRENT YEAR) 2013	<50
ADT (PROJECTED YEAR) 2033	<50
PAVEMENT DESIGN	N/A
ESALS (20)	N/A
R=VALUE	N/A
SOIL FACTOR	130%
DESIGN SPEED	55 MPH
BASED ON SIGHT DISTANCE	495'
HEIGHT OF EYE / HEIGHT OF OBJECT	3.5' / 2.0'
DESIGN SPEED NOT ACHIEVED AT:	N/A

Ronald L. Dokken
RONALD L. DOKKEN
DESIGN ENGINEER: I HEREBY CERTIFY THAT THIS PLAN (SHEETS 1-18) WAS PREPARED BY ME OR UNDER MY DIRECT SUPERVISION AND THAT I AM A DULY LICENSED PROFESSIONAL ENGINEER UNDER THE LAWS OF THE STATE OF MINNESOTA.

DATE 6/22/13 LICENSE NUMBER 13931

Alan VanWar
APPROVED: COUNTY ENGINEER DATE 7/12/13

Nancy Dambarger
RECOMMENDED FOR APPROVAL: STATE BRIDGE ENGINEER DATE 7/25/13

Paul J. Brumwell
DISTRICT STATE AID ENGINEER: REVIEWED FOR COMPLIANCE WITH STATE-AID RULES/POLICY DATE 9/4/13

Paul J. Brumwell
APPROVED FOR STATE-AID FUNDING: STATE-AID ENGINEER DATE 1/27/15

SUBSURFACE UTILITY NOTE
THE SUBSURFACE UTILITY INFORMATION IN THIS PLAN IS UTILITY QUALITY LEVEL D. THIS UTILITY QUALITY LEVEL WAS DETERMINED ACCORDING TO THE GUIDELINES OF CI/ASCE 38-02, ENTITLED "STANDARD GUIDELINES FOR THE COLLECTION AND DEPICTION OF EXISTING SUBSURFACE UTILITY DATA."

ADDENDUM #1

ERICKSON ENGINEERING
WWW.ERICKSON-ENG.COM 1-800-545-8020

STATE AID PROJECT NO. 042-598-043
SHEET NO. 1 OF 18 SHEETS

BRIDGE NO. 42568

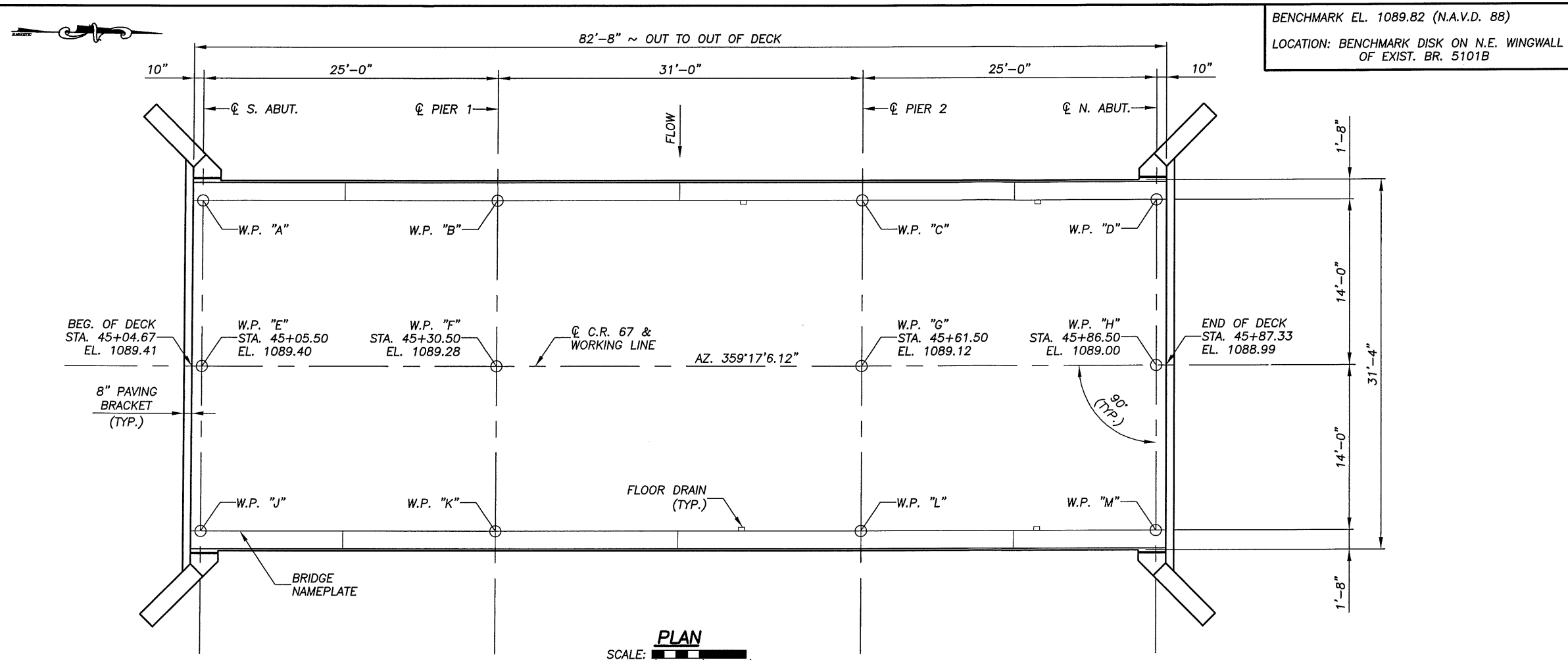

DESIGN DATA

2012 AND CURRENT INTERIM AASHTO LRFD BRIDGE DESIGN SPECIFICATIONS
 LOAD AND RESISTANCE FACTOR DESIGN METHOD
 HL-93 LIVE LOAD
 DEAD LOAD INCLUDES 20 POUND PER SQUARE FOOT ALLOWANCE FOR FUTURE WEARING COURSE MODIFICATIONS

MATERIAL DESIGN PROPERTIES:
REINFORCED CONCRETE
 $f'_c = 4$ KSI $n = 8$
 $F_y = 60$ KSI REINFORCEMENT
STRUCTURAL STEEL
 $F_y = 36$ KSI SPEC. 3306

DECK AREA = 2,591 SQ. FT. CURRENT ADT (2013) <50
 DESIGN SPEED = 55 MPH PROJ. ADT (2033) <50
 HL 93 LRFR OPERATING RATING RF = 1.69

LIST OF SHEETS

NO.	TITLE
1	TITLE SHEET
2	GENERAL PLAN & ELEVATION
3	TYPICAL SECTION & QUANTITIES
4	BRIDGE LAYOUT
5-6	ABUTMENT
7-8	PIER
9-11	SUPERSTRUCTURE
12	CONCRETE BARRIER (TYPE F, TL-4)
13-16	MISC. BRIDGE DETAILS
17	BRIDGE SURVEY
18	BRIDGE SURVEY ~ PLAN & PROFILE

APPROVED: *Han Carter*
 LYON COUNTY ENGINEER
 DATE: 7/12/13

I HEREBY CERTIFY THAT THIS PLAN (SHEETS 1-18) WAS PREPARED BY ME OR UNDER MY DIRECT SUPERVISION AND THAT I AM A DULY LICENSED PROFESSIONAL ENGINEER UNDER THE LAWS OF THE STATE OF MINNESOTA.

Ronald L. Dokken
 RONALD L. DOKKEN
 DATE: 6/22/13 LIC. NO. 13931

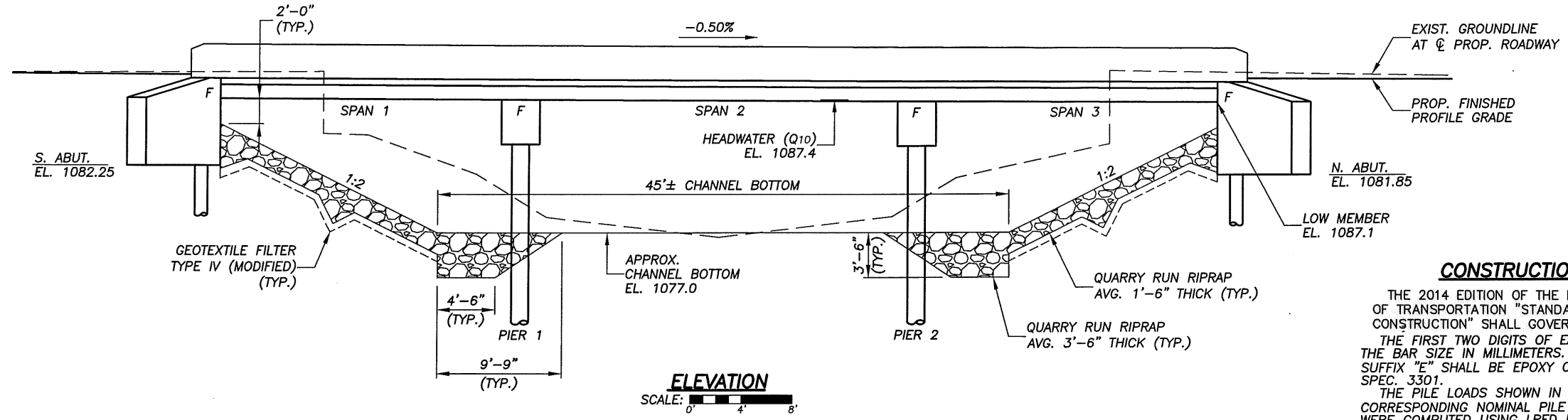

CONSTRUCTION NOTES

THE 2014 EDITION OF THE MINNESOTA DEPARTMENT OF TRANSPORTATION "STANDARD SPECIFICATION FOR CONSTRUCTION" SHALL GOVERN.

THE FIRST TWO DIGITS OF EACH BAR MARK INDICATE THE BAR SIZE IN MILLIMETERS. BARS MARKED WITH THE SUFFIX "E" SHALL BE EPOXY COATED IN ACCORDANCE WITH SPEC. 3301.

THE PILE LOADS SHOWN IN THE PLANS AND CORRESPONDING NOMINAL PILE BEARING RESISTANCE (R_n) WERE COMPUTED USING LRFD METHODOLOGY. PILE BEARING RESISTANCE DETERMINED IN THE FIELD SHALL INCORPORATE THE METHODS AND/OR FORMULAS DESCRIBED IN THE SPECIAL PROVISIONS.

THE SURVEY USED IN DEVELOPING THIS BRIDGE PLAN MUST BE VERIFIED WITH THE ACTUAL STREAM LOCATION AT THE TIME OF CONSTRUCTION STAKING. IF THE BRIDGE POSITION IS NOT COMPATIBLE WITH THE STREAM, THE ENGINEER SIGNING THESE PLANS SHALL BE NOTIFIED.

IT IS THE CONTRACTOR'S RESPONSIBILITY TO DISPOSE OF ALL EXCESS EXCAVATED MATERIAL OFF SITE.

NOTE:
 ABUTMENT PILES ARE TO BE 12" C-I-P CONCRETE PILES WITH PILE POINTS.
 PIER PILES ARE TO BE 16" C-I-P CONCRETE PILES WITH PILE POINTS.

ADDENDUM #1

EE ERICKSON ENGINEERING
 9330 JAMES AVENUE SOUTH
 BLOOMINGTON, MN 55431

C.R. 67 LYON COUNTY
 MINNESOTA DEPARTMENT OF TRANSPORTATION

BRIDGE NO. 42568
 LOCATED 1.0 MILES NORTH OF JCT. C.S.A.H. 8 ON C.R. 67 OVER THREE MILE CREEK
 25'-31'-25' CONTINUOUS CONC. SLAB SPANS
 28' ROADWAY ~ 0' SKEW
 SPAN IDENTIFICATION NO. 209
GENERAL PLAN & ELEVATION
 SEC. 2 TWP. 112 N R 41 W

TOWNSHIP: FAIRVIEW
 COUNTY: LYON
 APPROVED: *Nancy Daubertgen*
 STATE BRIDGE ENGINEER
 DATE: 7/25/13

DES.: DSN	DRN.: CJA	BRIDGE NO. 42568
CHK.: SWE	CHK.: DSN	
S.A.P. 042-598-043		
SHEET 2 OF 18 SHEETS		